

## 4500 Series Storefront Framing

Our 4500 Series Storefront framing is ideal for a wide variety of interior or low-rise exterior applications. Profiles of 1-3/4" x 4-1/2" are designed for 1/4" to 3/8" exterior glazing, and can be assembled by screw spline or clip joinery. The roll-in gasket is easy to install at the interior and exterior of the glass. The 1-3/4" framing is compatible with Tubelite Narrow, Medium and Wide Stile Doors.

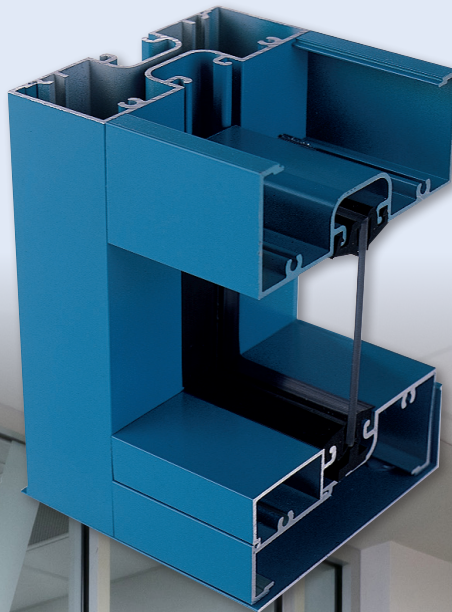

Standard Medium Stile Entrances

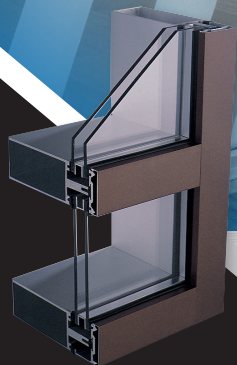

200 Series Curtainwall

ALSO  
USED  
WITH

**TUBELITE<sup>®</sup>**  
**DEPENDABLE**

LEADERS IN ECO-EFFICIENT STOREFRONT,  
CURTAINWALL AND ENTRANCE SYSTEMS

## 4500 Series Storefront Framing

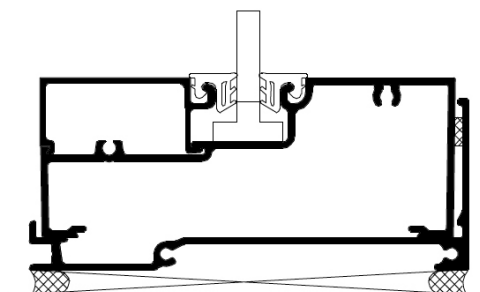
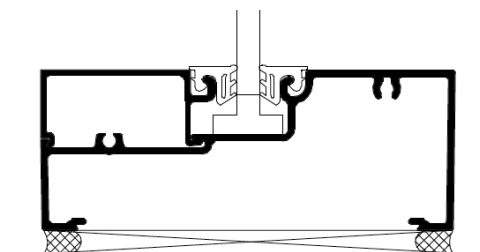
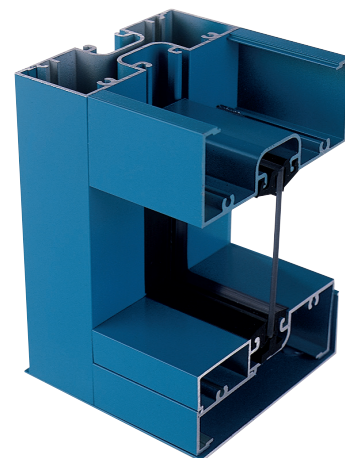
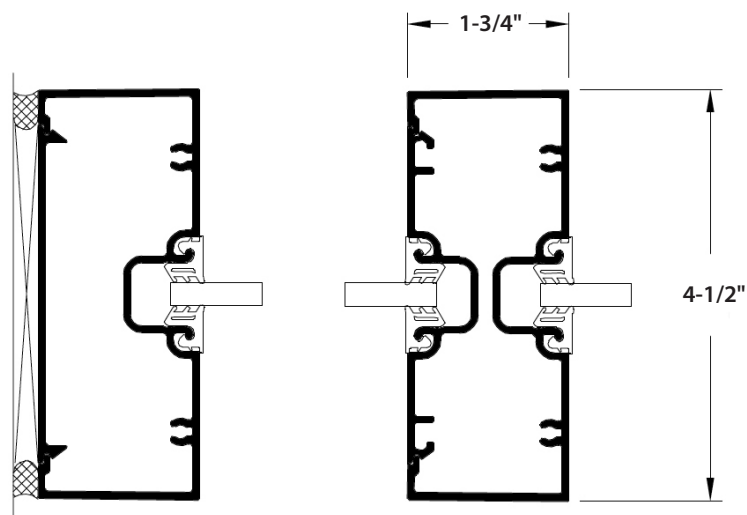

### System Features:

- Standard 1 3/4" (44.5mm) sight-line on verticals and horizontals
- 4-1/2" (114.3mm) system depth
- EPDM wedge type gaskets for 1" glass or panel thickness
- Glass centered in the system depth

### Optional Features:

- Screw-spline or shear block connections
- Steel reinforcing if required
- Easily integrates with standard doors & operable vent windows
- A wide variety of standard anodized and painted colors are available to complement any project with warranted protection, as well as street appeal.

### 4500 Series Product Specifications

**Application:** Low and mid-rise commercial buildings including retail, office, healthcare, schools, etc.

**Description:** 1-3/4" x 4-1/2" center set, screw spline or shear block construction non thermal storefront field glazed, shear block construction storefront.

Face Width:	Overall Depths:	Glass:	Air Infiltration:	Water Infiltration:	Structural:	Acoustic:
1-3/4"	4-1/2"	1/4" std. (3/16" to 3/8")	0.06 CFM/Ft.2 @ 6.24 PSF	12 PSF - Static 12 PSF - Dynamic	30 PSF - Design 45 PSF - Overload	28 STC 27 OITC

DISCLAIMER: Tubelite takes no responsibility for product selection or application, including, but not limited to, compliance with building codes, safety codes, laws, merchantability or fitness for a particular purpose; and further disclaims all liability for the use, in whole or in part, of this Technical Guide in preparation of project specifications and/or other documents. Technical Guides are subject to change at any time, without notice, and at Tubelite's sole discretion. ©2020 Tubelite Inc.

072920